

THIS DRAWING IS TO BE USED ONLY FOR THE PURPOSE OF ISSUE THAT IT WAS ISSUED FOR AND IS SUBJECT TO AMENDMENT

LEGEND

Order Limits

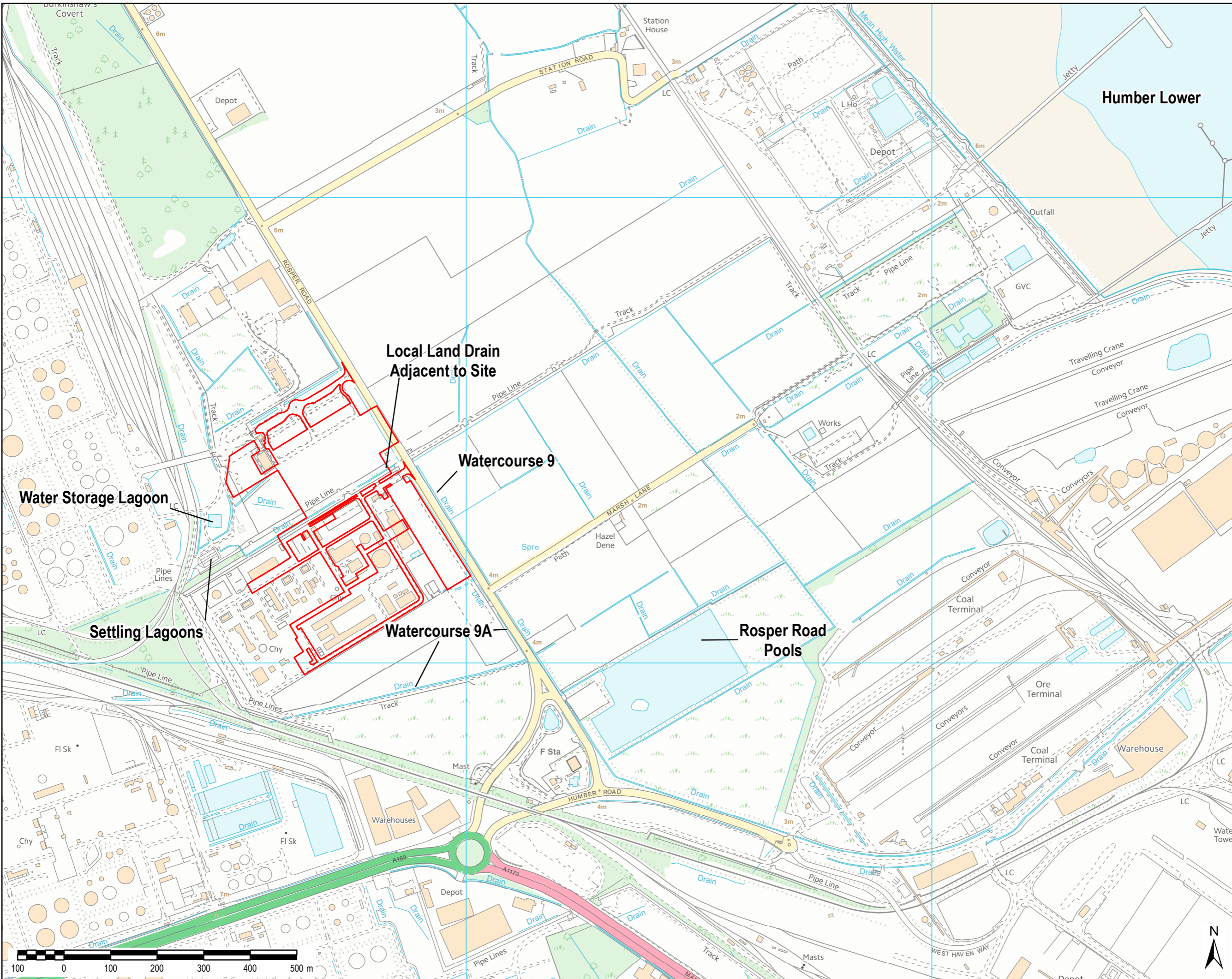

Copyright
 Reproduced from Ordnance Survey digital map data
 © Crown copyright 2019. All rights reserved.
 Licence number 0100031673.

Purpose of Issue
ENVIRONMENTAL STATEMENT

Client
VPI IMMINGHAM B LTD

Project Title
**THE VPI IMMINGHAM
 OCGT PROJECT**

Drawing Title
**SURFACE WATER FEATURES
 WITHIN THE STUDY AREA
 FIGURE 12.1**

Drawn TD	Checked DH	Approved MS	Date 05/04/2019
AECOM Internal Project No. 60547702		Scale @ A3 1:7,500	

THIS DOCUMENT HAS BEEN PREPARED PURSUANT TO AND SUBJECT TO THE TERMS OF AECOM'S APPOINTMENT BY ITS CLIENT. AECOM ACCEPTS NO LIABILITY FOR ANY USE OF THIS DOCUMENT OTHER THAN BY ITS ORIGINAL CLIENT OR FOLLOWING AECOM'S EXPRESS AGREEMENT TO SUCH USE, AND ONLY FOR THE PURPOSES FOR WHICH IT WAS PREPARED AND PROVIDED.

AECOM
 Midpoint
 Alencor Link, Basingstoke
 Hampshire, RG21 7PP
 Telephone (01256) 310200
 Fax (01256) 310201
 www.aecom.com

DCO Document Ref
6.3.20

File Name: K15004 - Information Systems\60547702\Immingham Gas Pipeline\02_Maps\Power Plant Site\OCGT Full ES 2019\Figure 12.1 Surface Water Features within the Study Area.mxd